

NOTES:

- 1) SYSTEM AMBIENT OPERATING TEMPERATURE RANGE: 40°F TO 120°F.
- 2) SYSTEM OPERATING PRESSURE RANGE: 60 PSIG TO 150 PSIG.
- 3) SYSTEM INLET OPERATING TEMPERATURE RANGE: 40°F TO 120°F.
- 4) SYSTEM RATED FLOW: 500 SCFM @ 100 PSIG, 100°F.
- 5) APPROXIMATE WEIGHT OF UNIT: 705 LBS (WITHOUT DESICCANT).
: 1240 LBS (WITH DESICCANT).

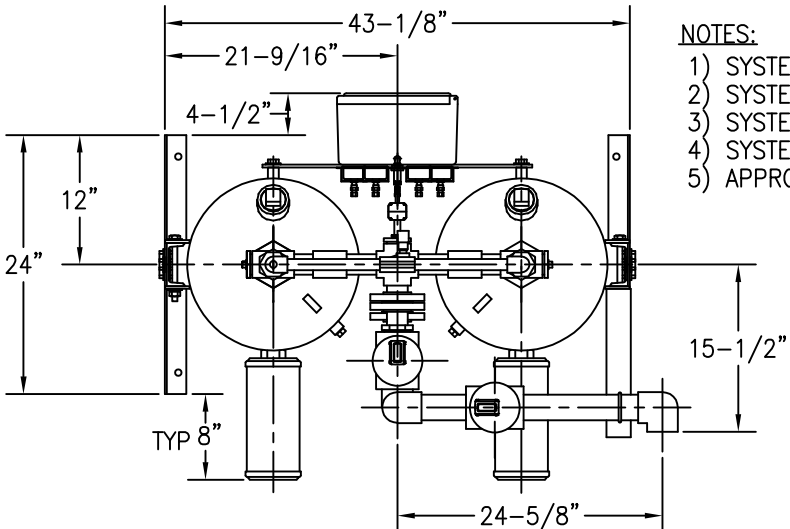

APPL	DATE	LVL	REVISION
SCF	02-01-96	A	ECN:5448
SCF	06-28-96	B	ECN:0718
04-09-98		C	ECN:0829

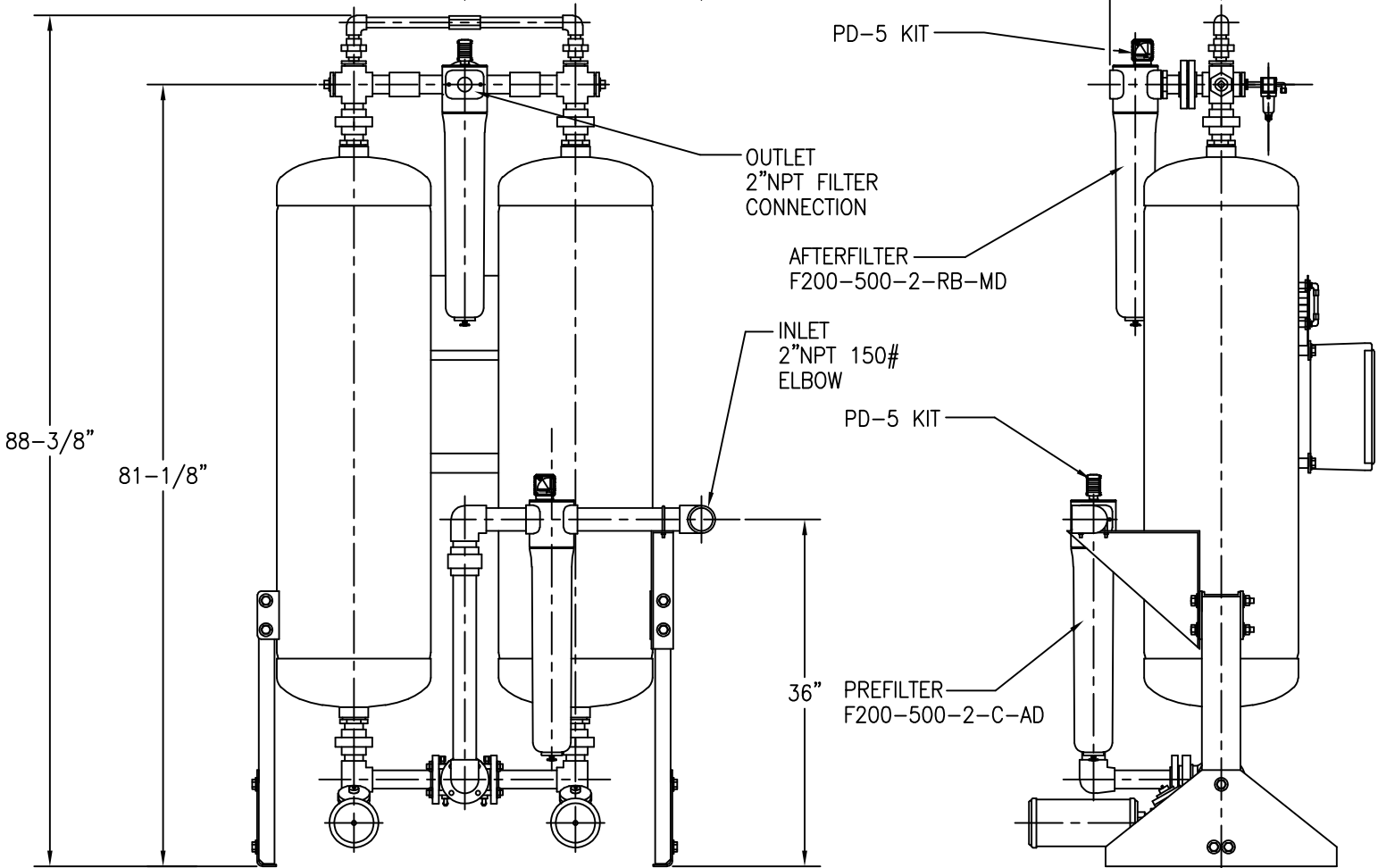

**HEATLESS REGENERATIVE DRYER HL-500
WITH MOUNTED FILTERS**

This drawing is the property of **VAN AIR SYSTEMS INC** and is subject to return upon request. It shall not be copied or duplicated in any manner and shall not be submitted to outside parties for examination without the consent of Van Air Systems Inc. It shall be used for reference to work under contract or proposals submitted by Van Air Systems Inc. only.

DRWN BY: JPK	DATE: 03-29-95	DRWG No.	SD-13086	REV
CHECKED:	SCALE: NONE			C
APPL:				

VAN AIR SYSTEMS INC

Lake City, PA 16423 (814)774-2631 Fax: 814/774-3482 Telex: 91-4548